

# COREAT

ELECTRIC CHAIN HOIST

环链葫芦 • 控制系统 • 解决方案

CHAIN HOISTS • CONTROL SYSTEMS • SOLUTIONS

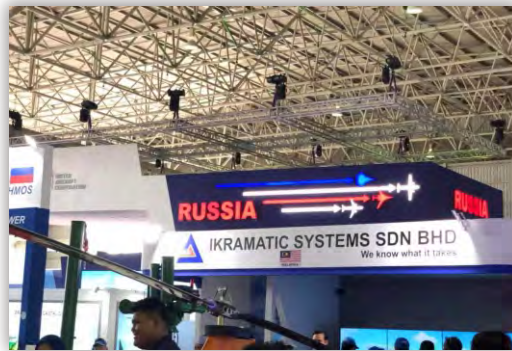
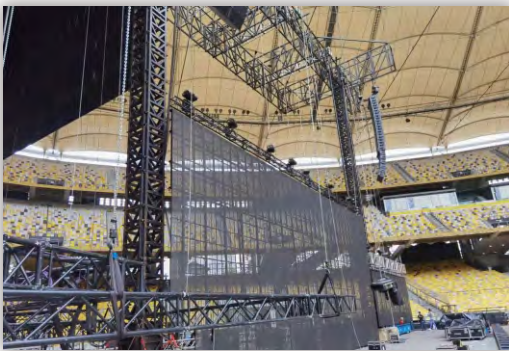

广东科励宝舞台科技有限公司  
Guangdong Coreat Stage Technology Co., Ltd

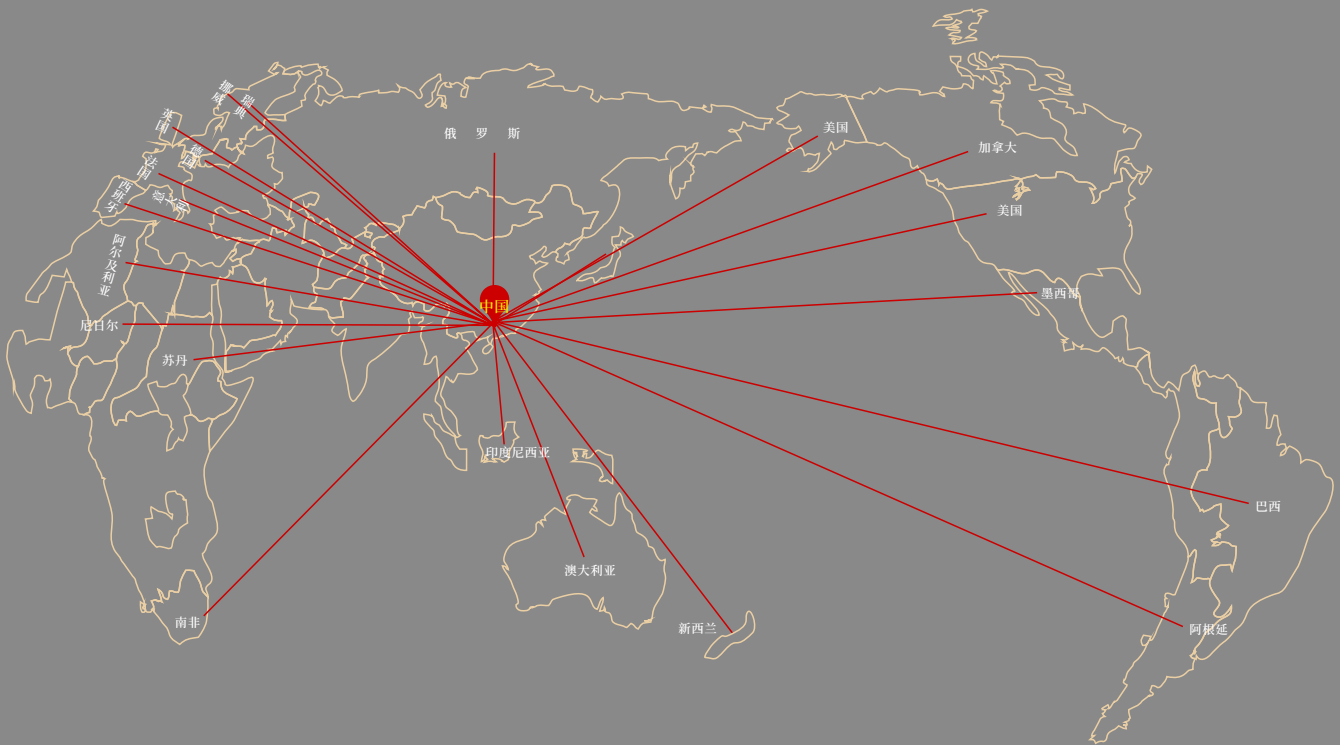

科励宝走向世界，产品和服务遍及100多个国家和地区  
Coreat goes to the world with products and services in more than 100 countries and regions

## 企业简介/Company profile

广东科励宝舞台科技有限公司是一家集研发、设计、生产、销售、安装调试、技术服务于一体的专业舞台设备生产企业，公司拥有专业的技术团队和一流的生产设备，始终将技术创新作为企业发展的核心驱动力，凭借多年的经验积累和技术创新，为国内外客户提供了高品质的舞台电动葫芦。

我们实施严谨的品质管理，产品已通过欧盟国际CE认证、SGS检测、国家起重运输机械质量检测，并在多个方面取得了显著的科研成果，荣获多项专利技术。产品广泛应用于礼堂剧院、演播厅、体育场馆、娱乐酒吧派对场、展览展示厅、流动演出等领域。

多年来，公司以优良的品质和严格的标准赢得了行业认可，受到社会各界的好评，是广东演艺设备行业商会理事单位、广东省广西商会演艺设备专业委员会执行会长单位。高质量的产品和过硬的服务在国际上备受专业用户的欢迎和推崇。

Guangdong Coreat Stage Technology Co., Ltd. is a professional stage equipment manufacturer integrating R&D, design, production, sales, installation, debugging and technical services. Our company has a professional technical team and first-class production equipment, we always regard technological innovation as the core driving force of enterprise development, and with years of experience accumulation and technological innovation, we provide high-quality stage electric hoist for domestic and foreign customers.

We implement strict quality management, and our products have passed the international CE certification of the European Union, SGS testing, and national quality testing of lifting and transportation machinery, and have made remarkable scientific research achievements in many aspects and won many patented technologies. Products are widely used in auditoriums, theaters, studios, stadiums, entertainment bars, parties, exhibition halls, mobile performances and other fields.

Over the years, our company has won industry recognition with excellent quality and strict standards, and has been praised by all walks of life. And is the director unit of Guangdong Performing Arts Equipment Industry Chamber of Commerce, Guangdong Province Guangxi Chamber of Commerce Executive Chairman Unit of Performing Arts Equipment Professional Committee. High-quality products and excellent service are welcomed and respected by professional users internationally.



# ▶ 企业荣誉/Corporate honor

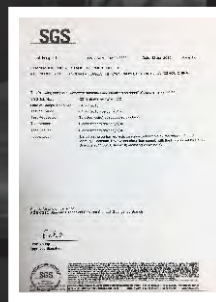
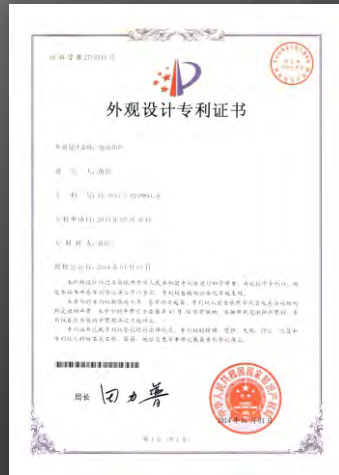
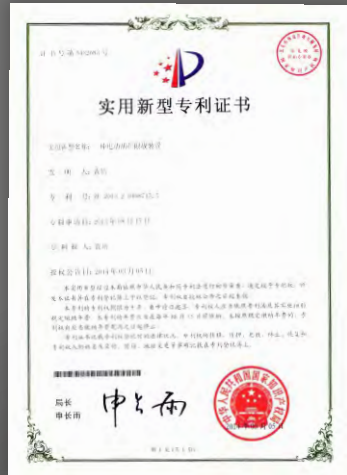





# ▶ 环链电动葫芦/Electric chain hoist

## 环链电动葫芦/Electric chain hoist

Coreat强力推出新一代高品质铝合金铸造成型电动葫芦，整体外观欧式设计风格，新颖美观大方,易于安装使用,操控便捷，新一代升级版全铸造铝合金壳体电动葫芦，IP56全防水结构设计，安全稳定的专利刹车系统，配套智能操作系统，让演出升降吊挂智能简单化。主要适用于舞台搭建或流动演出，舞台置景，音响，灯光吊挂，展馆，展厅、体育馆，电视台等。

Coreat strongly launched a new generation of high-quality aluminum alloy casting electric hoist, overall appearance European design style,novel and beautiful, easy to install and use,easy to control,a new generation of upgraded version of fully cast aluminum alloy shell electric hoist,IP56 fully waterproof structure design, safe and stable patented braking system, supporting intelligent operating system, making the performance lifting and hanging intelligent and simple. Mainly suitable for stage construction or mobile performance, stage setting, sound, lighting hanging, exhibition hall, exhibition hall, gymnasium, TV station, etc.

## 优势&功能

### 5链窝起重链轮

减少链条磨损，更平稳

### 新设计控制面板

简单操控

### 重负载直流刹车

长使用寿命设计，易于维修

### 齿轮

螺旋状设计使用寿命更长，操作更平稳

### 限位开关功能

选配旋转极限开关，为快速重置和限位行程定位提供方便，能预设链条长度范围内的任何上下停留位置，只需要轻拨动限位器的小拨片即可，且可多次重复调节不同位置，使用简单

### 超载保护

超载保护防止极度超载，有效避免因极度超载引起的危险

### 运输方便

易于搬运及携带

### 终身保修

符合行业最高标准

**传动装置：**高精度斜齿轮传动，齿轮在一个永久润滑系统内，齿轮运行中更顺畅、静音，延长使用寿命。

**可靠性：**葫芦配有专利超载保护离合器，能在发生超载时保护操作者及吊挂设备的安全和产品不受损坏。

☆高强度PVC链条收容袋，正挂或倒挂使用。

☆360度可旋转上下吊钩，配有安全锁片。

☆欧式防水航空插头。

☆整机设计正挂或倒挂使用，无需改装。

## Advantages & Features

### 5 chain socket lifting sprocket

Less chain wear, smoother

### New design control panel

Simple control

### Heavy duty DC brakes

Long service life design, easy to repair

### Gear

The spiral design lasts longer and operates more smoothly

### Limit switch function

Optional rotary limit switch, facilitates quick reset and limit stroke positioning, any up and down position within the chain length range can be preset, just flick the small paddle of the limiter, and can be repeatedly adjusted different positions, easy to use.

### Overload protection

Overload protection prevents extreme overload, effectively avoid the danger caused by extreme overload.

### Easy to transport

Easy to handle and carrying

### Lifetime warranty

Meets the highest standards in the industry

### Transmission

High-precision helical gear transmission, the gears are in a permanent lubrication system, smoother, quieter gear operation and longer service life.

### Reliability

The hoist is equipped with a patented overload protection clutch, It protects the operator and the hanging equipment from damage in the event of overload.

☆High-strength PVC chain containment bag, hanging or upside down.

☆360 degree rotatable upper and lower hooks, equipped with safety lock plates.

☆European waterproof aviation plug.

☆The whole machine is designed to be used upside down or upside down without modification.

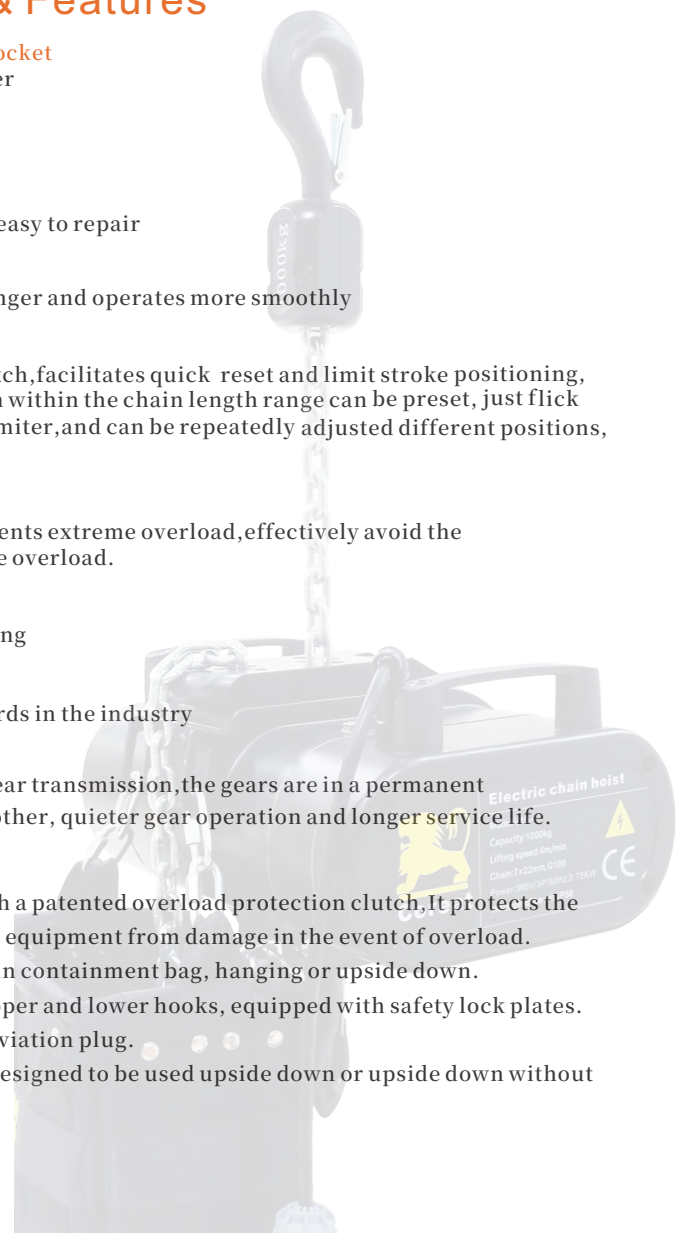



# ▶ 环链电动葫芦V系列/Electric chain hoist V series

## 型号/Model: V10/V10+

### 起重链条

7×22mm镀锌链条, 8倍安全系数G100级优质合金钢起重专用链条, 符合DIN5687, DIN5688德国标准和ISO3067中国标准, 镀锌链条能够在各种复杂的环境中保护链条不受腐蚀。匹配加工中心一次性成型5轮窝链轮, 加强链条与链轮的啮合, 确保链条平稳运行。

### Lifting Chain

7 x 22mm galvanized chain, 8 times safety factor G100 high quality alloy steel lifting special chain, in line with DIN5687, DIN5688 German standard and ISO3067 Chinese standard, galvanized chain can protect the chain from corrosion in various complex environments. Five wheel socket sprocket is formed by matching machining center at one time to strengthen the mesh between chain and sprocket to ensure smooth operation of chain.

### 导链轮

耐磨尼龙导链轮, 保持链条出入顺畅不与箱体摩擦。

### Guide sprocket

Wear-resistant nylon guide sprocket keeps the chain in and out smoothly without friction with the box.

### 箱体

可靠耐用的箱体结构。

### shell

Reliable and durable box construction.

### 链袋

可拆卸的高强度黑色PVC涂层布制成。

### Chain bag

Removable high strength black PVC coated fabric made of.

### 吊钩

可旋转360°锻造合金钢吊钩, 适合各种安装角度。

### Hook

It can rotate 360° forged alloy steel hook to suit various installation angles.

★高强度直流电刹车系统专为较长使用寿命而设计;

★高性能无油齿轮箱和耐磨度高的轴承配合, 确保在整机运作过程中有更好的耐磨性和平稳性;

★高劳动强度级别的电机

★High-strength DC braking system is designed for long service life;

★High-performance oil-free gearbox and bearing with high wear resistance. Ensure better wear resistance and stability during the operation of the whole machine;

★High labor intensity level motor.

### 全密封端盖

端盖O形圈密封, 户外使用防水性好。

### Fully sealed end cover

Between the covers connecting part have "O" style ring to keep the sealed waterproof function.

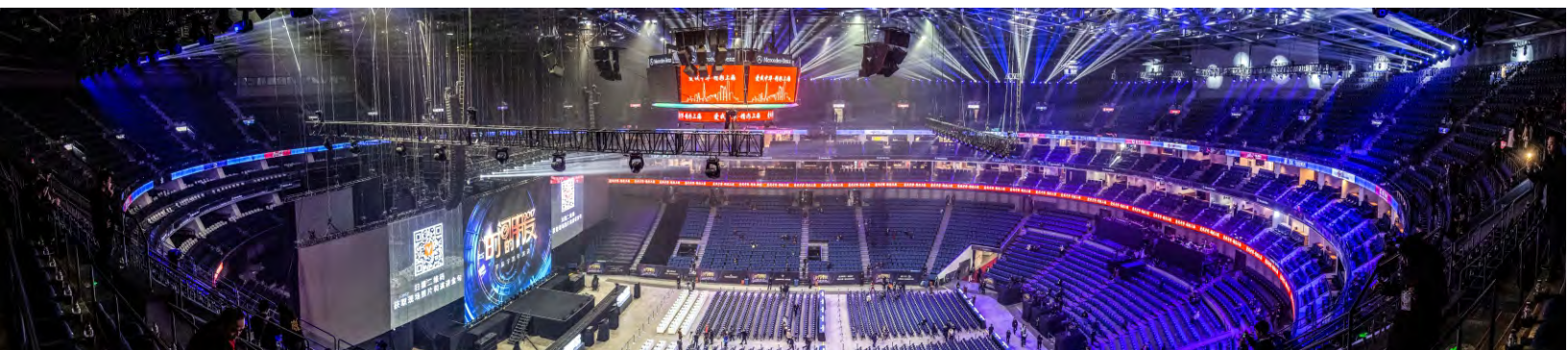



# ▶ 环链电动葫芦V系列/Electric chain hoist V series

型号/Model: V10/V10+

## 产品主要技术参数/Main technical parameters of the product

型号 Model	额定负载 Rated load (kg)	提升速度 Lifting Speed (m/min)	工作电压 Power supply	电机功率 Motor power (kw)	链条规格 Chain specification (mm)	链条安全系数 Chain safety factor	链条数 Chain Qty	葫芦重量 Hoist weight (kg)	链条重量 Chain weight (kg/m)	防护等级 Degree of protection	绝缘等级 Insulation class	刹车系统 Braking system
V10	1000	4	415V/50Hz/3P 380V/50Hz/3P	0.75	7×22	8.95	1	32.5	1	IP56	F	单 single
V10+	1000	4	220V/50Hz/3P	0.75	7×22	8.95	1	39	1	IP56	F	双 double

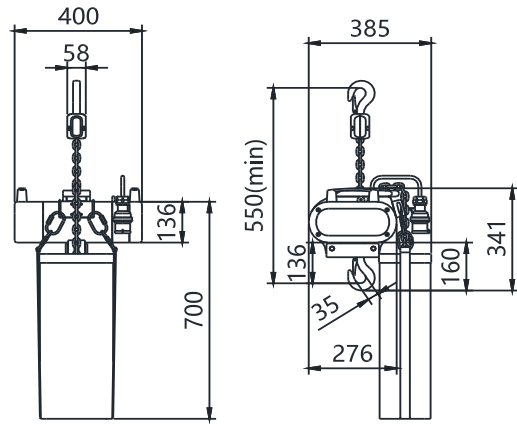

型号/Model: V10

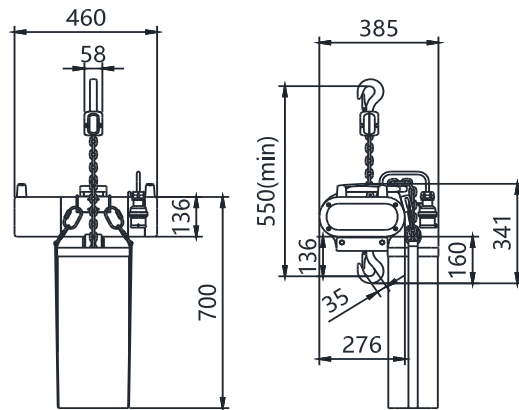

型号/Model: V10+





# ► 环链电动葫芦V系列/Electric chain hoist V series

## 型号/Model: V20

### 起重链条

7×22mm镀锌链条，8倍安全系数G100级优质合金钢起重专用链条，符合DIN5687, DIN5688德国标准和ISO3067中国标准，镀锌链条能够在各种复杂的环境中保护链条不受腐蚀。匹配加工中心一次性成型5轮窝链轮，加强链条与链轮的啮合，确保链条平稳运行。

### Lifting Chain

7 x 22mm galvanized chain, 8 times safety factor G100 high quality alloy steel lifting special chain, in line with DIN5687, DIN5688 German standard and ISO3067 Chinese standard, galvanized chain can protect the chain from corrosion in various complex environments. Five wheel socket sprocket is formed by matching machining center at one time to strengthen the mesh between chain and sprocket to ensure smooth operation of chain.

### 导链轮

耐磨尼龙导链轮,保持链条出入顺畅不与箱体摩擦。

### Guide sprocket

Wear-resistant nylon guide sprocket keeps the chain in and out smoothly without friction with the box.

### 箱体

可靠耐用的箱体结构。

### shell

Reliable and durable box construction.

### 链袋

可拆卸的高强度黑色PVC涂层布制成。

### Chain bag

Removable high strength black PVC coated fabric made of.



### 吊钩

可旋转360°锻造合金钢吊钩,适合各种安装角度。

### Hook

It can rotate 360° forged alloy steel hook to suit various installation angles.

★高强度直流电刹车系统专为较长使用寿命而设计;

★高性能无油齿轮箱和耐磨度高的轴承配合,确保在整机运作过程中有更好的耐磨性和平稳性;

★高劳动强度级别的电机

★High-strength DC braking system is designed for long service life;

★High-performance oil-free gearbox and bearing with high wear resistance, Ensure better wear resistance and stability during the operation of the whole machine;

★High labor intensity level motor.

### 全密封端盖

端盖O形圈密封,户外使用防水性好。

### Fully sealed end cover

Between the covers connecting part have "O" style ring to keep the sealed waterproof function.







# ▶ 环链电动葫芦V系列/Electric chain hoist V series

型号/Model: V20

## 产品主要技术参数/Main technical parameters of the product

型号 Model	额定负载 Rated load (kg)	提升速度 Lifting Speed (m/min)	工作电压 Power supply	电机功率 Motor power (kw)	链条规格 Chain specification (mm)	链条安全系数 Chain safety factor	链条数 Chain Qty	葫芦重量 Hoist weight (kg)	链条重量 Chain weight (kg/m)	防护等级 Degree of protection	绝缘等级 Insulation class	刹车系统 Braking system
V20	2000	2	415V/50Hz/3P 380V/50Hz/3P 220V/50Hz/3P	0.75	7×22	8.95	2	36.5	1	IP56	F	单/双 single/ double



型号/Model: V20

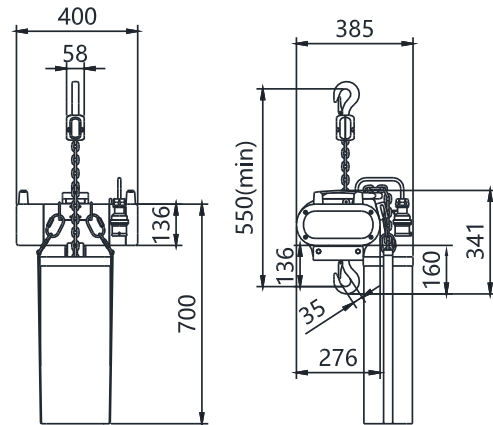

单刹车  
Single brake

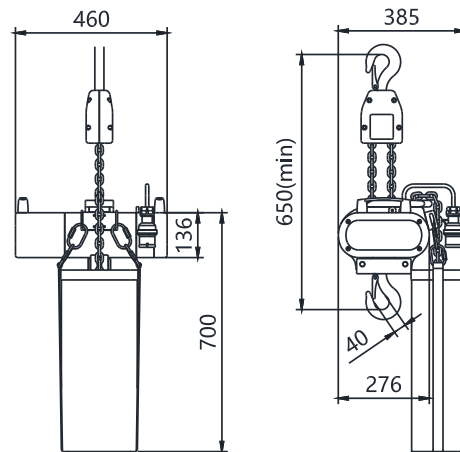

双刹车  
Double brakes



# ▶ 环链电动葫芦V系列/Electric chain hoist V series

Coreat强势推出高效耐用的2T单链环链电动葫芦，单根起重链条的设计，双刹车系统，更安全更稳定，更符合广大用户对吊挂的需求，满足大型演出，整体更易于运输，相比较双链葫芦，操控更简单。

Coreat launches the highly efficient and durable 2T single-chain electric hoist, the design of a single lifting chain, double brake system, safer and more stable, more in line with the needs of the majority of users for hanging, meet the large-scale performance, overall easier to transport, compared with the double-chain hoist, the control is simpler.

## 型号/Model:V20+

### 起重链条

10×30mm镀锌链条，8倍安全系数G100级优质合金钢起重专用链条，符合DIN5687,DIN5688德国标准和ISO3067中国标准，镀锌链条能够在各种复杂的环境中保护链条不受腐蚀。匹配加工中心一次性成型5轮窝链轮，加强链条与链轮的啮合，确保链条平稳运行。

### Lifting Chain

10 x 30mm galvanized chain, 8 times safety factor G100 high quality alloy steel lifting special chain, in line with DIN5687, DIN5688 German standard and ISO3067 Chinese standard, galvanized chain can protect the chain from corrosion in various complex environments. Five wheel socket sprocket is formed by matching machining center at one time to strengthen the mesh between chain and sprocket to ensure smooth operation of chain.

### 导链轮

耐磨尼龙导链轮,保持链条出入顺畅不与箱体摩擦。

### Guide sprocket

Wear-resistant nylon guide sprocket keeps the chain in and out smoothly without friction with the box.

### 箱体

可靠耐用的箱体结构。

### shell

Reliable and durable box construction.

### 链袋

可拆卸的高强度黑色PVC涂层布制成。

### Chain bag

Removable high strength black PVC coated fabric made of.

### 吊钩

可旋转360°锻造合金钢吊钩,适合各种安装角度。

### Hook

It can rotate 360°forged alloy steel hook to suit various installation angles.

- ☆高强度直流电双刹车系统专为较长使用寿命而设计；
- ☆高性能无油齿轮箱和耐磨度高的轴承配合，确保在整机运作过程中有更好的耐磨性和平稳性；
- ☆高劳动强度级别的电机

☆The high-strength DC dual brake system is designed for a long service life;

☆High-performance oil-free gearbox and bearing with high wear resistance, Ensure better wear resistance and stability during the operation of the whole machine;

☆High labor intensity level motor

### 全密封端盖

端盖O形圈密封, 户外使用防水性好。

### Fully sealed end cover

Between the covers connecting part have "O" style ring to keep the sealed waterproof function.





# ▶ 环链电动葫芦V系列/Electric chain hoist V series

型号/Model: V20+

## 产品主要技术参数/Main technical parameters of the product

型号 Model	额定负载 Rated load (kg)	提升速度 Lifting Speed (m/min)	工作电压 Power supply	电机功率 Motor power (kw)	链条规格 Chain specification (mm)	链条安全系数 Chain safety factor	链条数 Chain Qty	葫芦重量 Hoist weight (kg)	链条重量 Chain weight (kg/m)	防护等级 Degree of protection	绝缘等级 Insulation class	刹车系统 Braking system
V20+	2000	4	415V/50Hz/3P 380V/50Hz/3P 220V/50Hz/3P	1.8	10×30	8.95	1	88.3	2	IP56	F	双 double



正挂Hanging

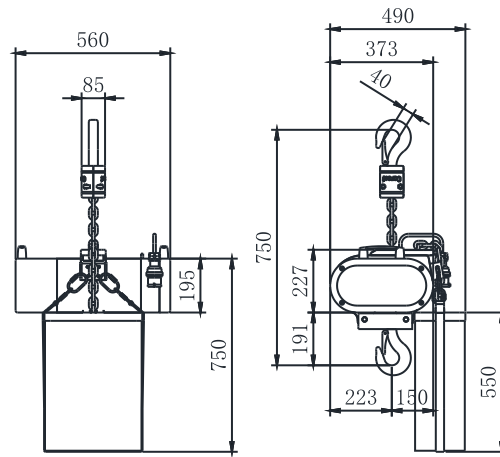

型号/Model: V20+



倒挂 Hang upside down





# ▶ 环链电动葫芦V系列/Electric chain hoist V series

## 型号/Model:V05/V05+

### 起重链条

6×18mm镀锌链条，8倍安全系数G100级优质合金钢起重专用链条，符合DIN5687,DIN5688德国标准和ISO3067中国标准，镀锌链条能够在各种复杂的环境中保护链条不受腐蚀。匹配加工中心一次性成型5轮窝链轮，加强链条与链轮的啮合，确保链条平稳运行。

### Lifting Chain

6 x 18mm galvanized chain, 8 times safety factor G100 high quality alloy steel lifting special chain, in line with DIN5687, DIN5688 German standard and ISO3067 Chinese standard, galvanized chain can protect the chain from corrosion in various complex environments. Five wheel socket sprocket is formed by matching machining center at one time to strengthen the mesh between chain and sprocket to ensure smooth operation of chain.

### 导链轮

耐磨尼龙导链轮,保持链条出入顺畅不与箱体摩擦。

### Guide sprocket

Wear-resistant nylon guide sprocket keeps the chain in and out smoothly without friction with the box.

### 链袋

可拆卸的高强度黑色PVC涂层布制成。

### Chain bag

Removable high strength black PVC coated fabric made of.

- ★高强度直流电刹车系统专为较长使用寿命而设计；
- ★高性能无油齿轮箱和耐磨度高的轴承配合，确保在整机运作过程中有更好的耐磨性和平稳性；
- ★高劳动强度级别的电机

- ★High-strength DC braking system is designed for long service life;
- ★High-performance oil-free gearbox and bearing with high wear resistance, Ensure better wear resistance and stability during the operation of the whole machine;
- ★High labor intensity level motor

### 箱体

可靠耐用的箱体结构，自重轻，体积小。

### shell

Reliable and durable box construction, Light weight, small size.

### 全密封端盖

端盖O形圈密封，户外使用防水性好。

### Fully sealed end cover

Between the covers connecting part have "O" style ring to keep the sealed waterproof function.







# ▶ 环链电动葫芦V系列/Electric chain hoist V series

型号/Model: V05/V05+

## 产品主要技术参数/Main technical parameters of the product

型号 Model	额定负载 Rated load (kg)	提升速度 Lifting Speed (m/min)	工作电压 Power supply	电机功率 Motor power (kw)	链条规格 Chain specification (mm)	链条安全系数 Chain safety factor	链条数 Chain Qty	葫芦重量 Hoist weight (kg)	链条重量 Chain weight (kg/m)	防护等级 Degree of protection	绝缘等级 Insulation class	刹车系统 Braking system
V05	500	4	415V/50Hz/3P 380V/50Hz/3P	0.4	6×18	8.95	1	27	0.75	IP56	F	单 single
V05+	500	4	220V/50Hz/3P	0.4	6×18	8.95	1	31.7	0.75	IP56	F	双 double

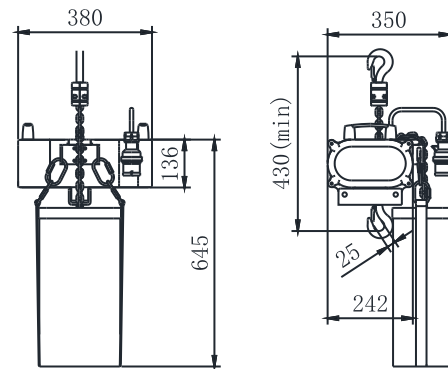

型号/Model: V05

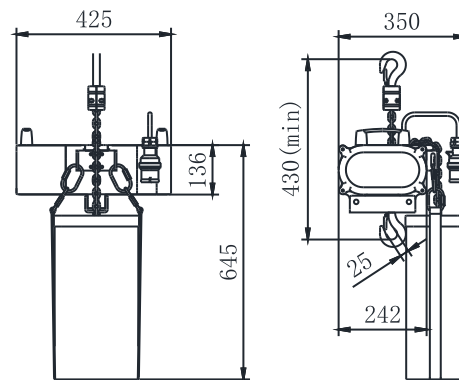

型号/Model: V05+



# ▶ 环链电动葫芦C系列/Electric chain hoist C series

## 型号/Model:C10

### 起重链条

7×22mm镀锌链条, 8倍安全系数G100级优质合金钢起重专用链条, 符合DIN5687, DIN5688德国标准和ISO3067中国标准, 镀锌链条能够在各种复杂的环境中保护链条不受腐蚀。匹配加工中心一次性成型5轮窝链轮, 加强链条与链轮的啮合, 确保链条平稳运行。

### Lifting Chain

7 x 22mm galvanized chain, 8 times safety factor G100 high quality alloy steel lifting special chain, in line with DIN5687, DIN5688 German standard and ISO3067 Chinese standard, galvanized chain can protect the chain from corrosion in various complex environments. Five wheel socket sprocket is formed by matching machining center at one time to strengthen the mesh between chain and sprocket to ensure smooth operation of chain.

### 导链轮

耐磨尼龙导链轮, 保持链条出入顺畅不与箱体摩擦。

### Guide sprocket

Wear-resistant nylon guide sprocket keeps the chain in and out smoothly without friction with the box.

### 链袋

可拆卸的高强度黑色PVC涂层布制成。

### Chain bag

Removable high strength black PVC coated fabric made of.

### 吊钩

可旋转360°锻造合金钢吊钩, 适合各种安装角度。

### Hook

It can rotate 360° forged alloy steel hook to suit various installation angles.

★高强度直流电刹车系统专为较长使用寿命而设计;

★高性能无油齿轮箱和耐磨度高的轴承配合, 确保在整机运作过程中有更好的耐磨性和平稳性;

★高劳动强度级别的电机

★High-strength DC braking system is designed for long service life;

★High-performance oil-free gearbox and bearing with high wear resistance, Ensure better wear resistance and stability during the operation of the whole machine;

★High labor intensity level motor

### 全密封端盖

端盖O形圈密封, 户外使用防水性好。

### Fully sealed end cover

Between the covers connecting part have "O" style ring to keep the sealed waterproof function.

### 箱体

可靠耐用的箱体结构。

### shell

Reliable and durable box construction.





# ▶ 环链电动葫芦C系列/Electric chain hoist C series

型号/Model: C10

## 产品主要技术参数/Main technical parameters of the product

型号 Model	额定负载 Rated load (kg)	提升速度 Lifting Speed (m/min)	工作电压 Power supply	电机功率 Motor power (kw)	链条规格 Chain specification (mm)	链条安全系数 Chain safety factor	链条数 Chain Qty	葫芦重量 Hoist weight (kg)	链条重量 Chain weight (kg/m)	防护等级 Degree of protection	绝缘等级 Insulation class	刹车系统 Braking system
C10	1000	4	415V/50Hz/3P 380V/50Hz/3P 220V/50Hz/3P	0.75	7X22	8.95	1	32.5	1	IP56	F	单/双 single/ double



型号/Model: C10

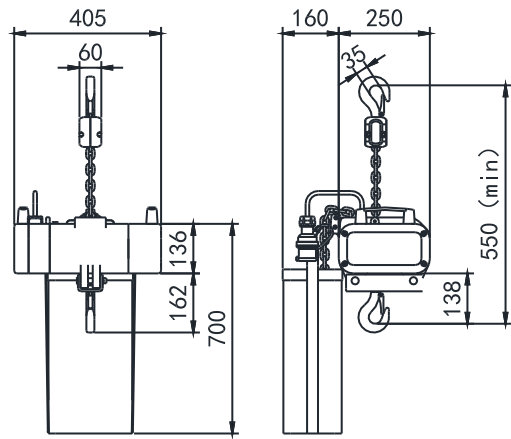

单刹车  
Single brake

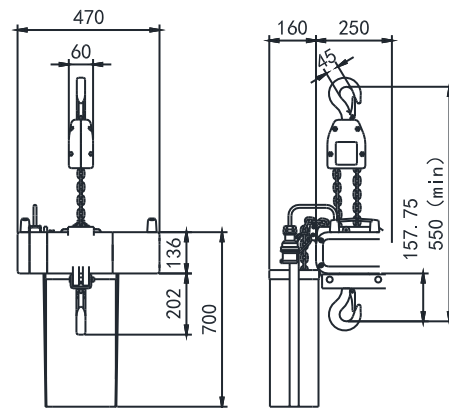

双刹车  
Double brakes





# ▶ 环链电动葫芦C系列/Electric chain hoist C series

## 型号/Model: C20

### 起重链条

7×22mm镀锌链条, 8倍安全系数G100级优质合金钢起重专用链条, 符合DIN5687, DIN5688德国标准和ISO3067中国标准, 镀锌链条能够在各种复杂的环境中保护链条不受腐蚀。匹配加工中心一次性成型5轮窝链轮, 加强链条与链轮的啮合, 确保链条平稳运行。

### Lifting Chain

7 x 22mm galvanized chain, 8 times safety factor G100 high quality alloy steel lifting special chain, in line with DIN5687, DIN5688 German standard and ISO3067 Chinese standard, galvanized chain can protect the chain from corrosion in various complex environments. Five wheel socket sprocket is formed by matching machining center at one time to strengthen the mesh between chain and sprocket to ensure smooth operation of chain.

### 导链轮

耐磨尼龙导链轮, 保持链条出入顺畅不与箱体摩擦。

### Guide sprocket

Wear-resistant nylon guide sprocket keeps the chain in and out smoothly without friction with the box.

### 链袋

可拆卸的高强度黑色PVC涂层布制成。

### Chain bag

Removable high strength black PVC coated fabric made of.

### 吊钩

可旋转360°锻造合金钢吊钩, 适合各种安装角度。

### Hook

It can rotate 360° forged alloy steel hook to suit various installation angles.

- ★高强度直流电刹车系统专为较长使用寿命而设计;
- ★高性能无油齿轮箱和耐磨度高的轴承配合, 确保在整机运作过程中有更好的耐磨性和平稳性;
- ★高劳动强度级别的电机
- ★High-strength DC braking system is designed for long service life;
- ★High-performance oil-free gearbox and bearing with high wear resistance, Ensure better wear resistance and stability during the operation of the whole machine;
- ★High labor intensity level motor.

### 全密封端盖

端盖O形圈密封, 户外使用防水性好。

### Fully sealed end cover

Between the covers connecting part have "O" style ring to keep the sealed waterproof function.

### 箱体

可靠耐用的箱体结构。

### shell

Reliable and durable box construction.

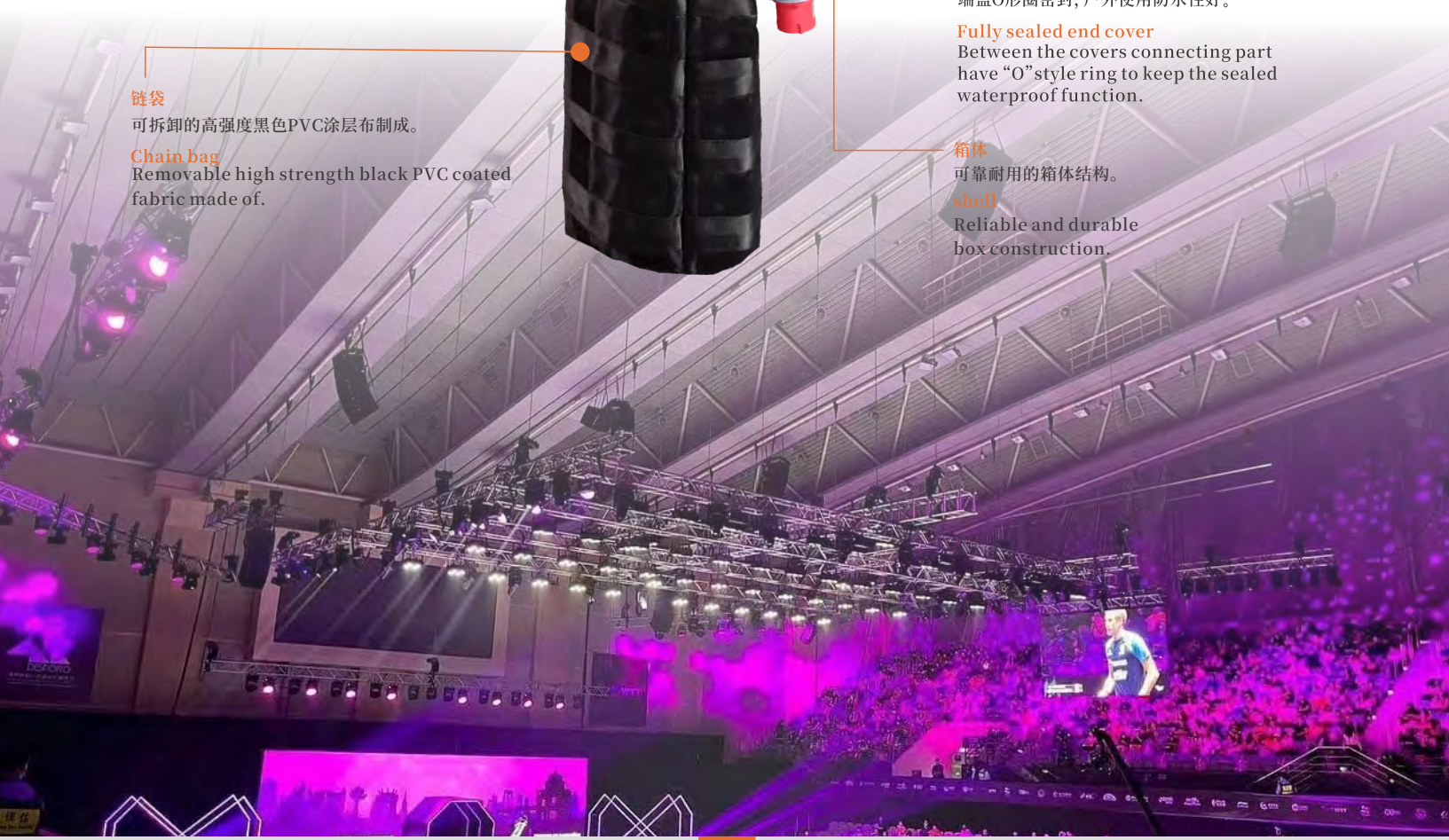





# ▶ 环链电动葫芦C系列/Electric chain hoist C series

型号/Model: C20

## 产品主要技术参数/Main technical parameters of the product

型号 Model	额定负载 Rated load (kg)	提升速度 Lifting Speed (m/min)	工作电压 Power supply	电机功率 Motor power (kw)	链条规格 Chain specification (mm)	链条安全系数 Chain safety factor	链条数 Chain Qty	葫芦重量 Hoist weight (kg)	链条重量 Chain weight (kg/m)	防护等级 Degree of protection	绝缘等级 Insulation class	刹车系统 Braking system
C20	2000	2	415V/50Hz/3P 380V/50Hz/3P 220V/50Hz/3P	0.75	7×22	8.95	2	36.5	1	IP56	F	单/双 single/ double



型号/Model: C20

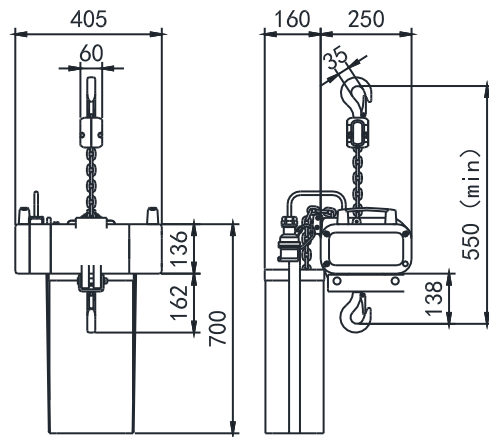

单刹车  
Single brake

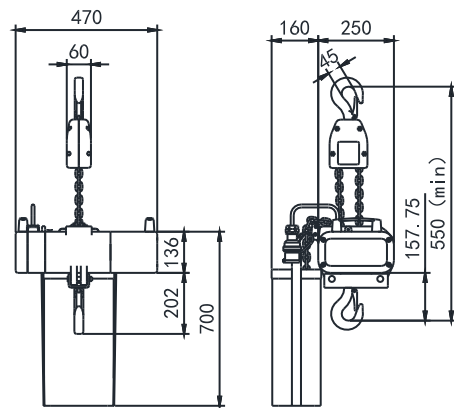

双刹车  
Double brakes



# ▶ 环链电动葫芦E系列/Electric chain hoist E series

## 环链电动葫芦/Electric chain hoist--E10

外壳为冲压、拉深钢构壳体，轻巧而坚固，结构紧凑，表面黑色哑光静电喷塑处理。

The shell is stamped and deep-drawn steel shell, light and strong, compact structure, black matte electrostatic spray treatment.

### 起重链条

7×22mm镀锌链条，8倍安全系数G100级优质合金钢起重专用链条，符合DIN5687, DIN5688德国标准和ISO3067中国标准，镀锌链条能够在各种复杂的环境中保护链条不受腐蚀。匹配加工中心一次性成型5轮窝链轮，加强链条与链轮的啮合，确保链条平稳运行。

### Lifting Chain

7 x 22mm galvanized chain, 8 times safety factor G100 high quality alloy steel lifting special chain, in line with DIN5687, DIN5688 German standard and ISO3067 Chinese standard, galvanized chain can protect the chain from corrosion in various complex environments. Five wheel socket sprocket is formed by matching machining center at one time to strengthen the mesh between chain and sprocket to ensure smooth operation of chain.

### 导链轮

耐磨尼龙导链轮，保持链条出入顺畅不与箱体摩擦。

### Guide sprocket

Wear-resistant nylon guide sprocket keeps the chain in and out smoothly without friction with the box.

### 链袋

可拆卸的高强度黑色PVC涂层布制成。

### Chain bag

Removable high strength black PVC coated fabric made of.



### 吊钩

可旋转360°锻造合金钢吊钩，适合各种安装角度。

### Hook

It can rotate 360° forged alloy steel hook to suit various installation angles.

★高强度直流刹车系统专为较长使用寿命而设计；

★高性能无油齿轮箱和耐磨度高的轴承配合，确保在整机运作过程中有更好的耐磨性和平稳性；

★高劳动强度级别的电机

★High-strength DC braking system is designed for long service life;

★High-performance oil-free gearbox and bearing with high wear resistance, Ensure better wear resistance and stability during the operation of the whole machine;

★High labor intensity level motor.

### 箱体

可靠耐用的箱体结构。

### shell

Reliable and durable box construction.



## 型号/Model:E10

### 产品主要技术参数/Main technical parameters of the product

型号 Model	额定负载 Rated load (kg)	提升速度 Lifting Speed (m/min)	工作电压 Power supply	电机功率 Motor power (kW)	链条规格 Chain specification (mm)	链条安 全系数 Chain safety factor	链条数 Chain Qty	葫芦重量 Hoist weight (kg)	链条重量 Chain weight (kg/m)	防护等级 Degree of protection	绝缘等级 Insulation class	刹车系统 Braking system
E10	1000	4	415V/50Hz/3P 380V/50Hz/3P 220V/50Hz/3P	0.75	7×22	8.95	1	34.8	1	IP54	F	单 single

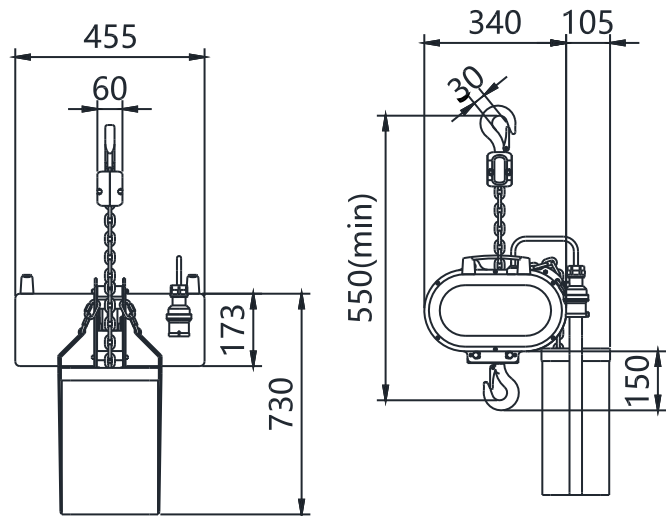

型号/Model: E10



# ▶ 智能数控葫芦/Intelligent CNC hoist

## 智能数控葫芦/Intelligent CNC hoist

Coreat智能数控电动葫芦，搭载国际通用最新的EtherCAT总线伺服系统，智能的运动控制方式和紧凑的一体化设计，轻质高强度铝合金壳体，可满足在大型活动、演唱会、电视节目及固定安装项目使用，产品具有超静音、易操作、绝对值精确定位的特点，最高速度32m/min，平滑精准的2D和3D运动更好的提升整体创意和舞台艺术呈现。

Coreat intelligent CNC electric hoist, it is equipped with the latest international EtherCAT bus servo system, Intelligent motion control mode and compact integrated design, lightweight and high-strength aluminum alloy shell, can meet the needs of large-scale events, For use in concerts, TV programs and fixed installation projects, the product is ultra-quiet, easy to operate, and absolute value is accurately determined. The features, the maximum speed is 32m/min, and the smooth and precise 2D and 3D movement can better enhance the overall creativity and stage art presentation.

## 优势&功能/Advantages&Features

- |                            |   |
|----------------------------|---|
| 1.正挂悬吊方式                   | 1.Straight hanging hanging mode                                   |
| 2.EtherCAT总线伺服电机           | 2.EtherCAT bus servo motor  |
| 3.多圈绝对值重复定位精度0.1mm         | 3.Multi-turn absolute value repeat positioning accuracy 0.1mm     |
| 4.符合国际安全标准EN61508/DIN56950 | 4. Meet the international safety standard EN61508/DIN56950        |
| 5.DAT级镀锌起重链条               | 5.DAT grade galvanized lifting chain                              |
| 6.即插即用，电脑或控制台配置设备编号        | 6. Plug and play, computer or console configuration device number |
| 7.简单接线，即插式电源、网线输出口         | 7. Simple wiring, plug-in power supply, network cable output port |

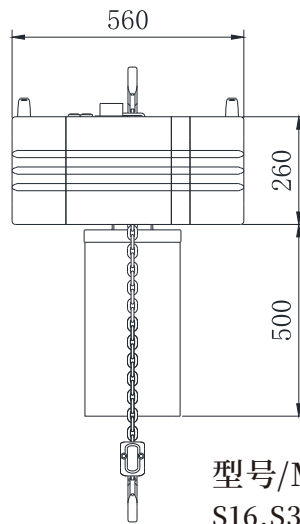

型号/Model:  
S16,S32

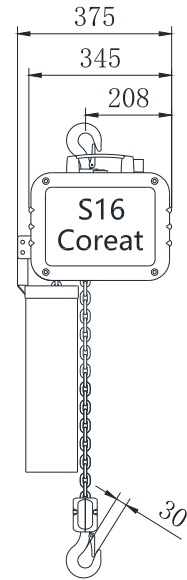

## 产品主要技术参数/Main technical parameters of the product

型号 Model	额定负载 Rated load (kg)	最快速度 Fastest speed (m/min)	工作电压 Power supply	电机功率 Motor power (kw)	链条规格 Chain specification (mm)	链条数 Chains Qty	链条安全系数 Chain safety factor	机械重量 Machine weight (kg)	链条重量 Chain weight (kg/m)	防护等级 Degree of protection	绝缘等级 Insulation class	刹车系统 Braking system
S16	1000	16	415V/50Hz/3P 380V/50Hz/3P	3	7×22	1	8.95	63.3	1	IP54	F	双 double
S32	500	32	220V/50Hz/3P	3	7×22	1	8.95	63.3	1	IP54	F	双 double



## 主要特点/Main features

- 自主研发专业机械数字控台,
- 15.6寸触摸屏,
- 2D/3D模拟软件,
- 10通道播控手动推杆,
- 多用途组合功能转轮,
- 多模式快捷选择键,
- 小键盘快速数值输入,
- 256轴运动控制,
- USB插口程序导入,
- 支持DMX512、TCP等外部通讯接口协议,
- 工作电压: 100-240V (50/60Hz) ,
- 外形尺寸: W486×D505×H160mm,
- 简单、直观、安全的布线系统
- 安装和拆卸时可对电动葫芦进行实时手动控制
- 可自由组合电动葫芦, 增加或减少电动葫芦数量, 无需重新编程
- 可选择加减速曲线, 直线插补、圆弧插补、螺旋线插补、空间圆弧
- 支持多任务, 多轴组, 多轴协同运动控制软件系统
- 远程控制可视化在线技术支持
- 软件急停或紧急停止系统
- 特制的专用航空箱, 最大限度的减少装载时间

## 智能数控葫芦系统图

Intelligent CNC hoist system diagram

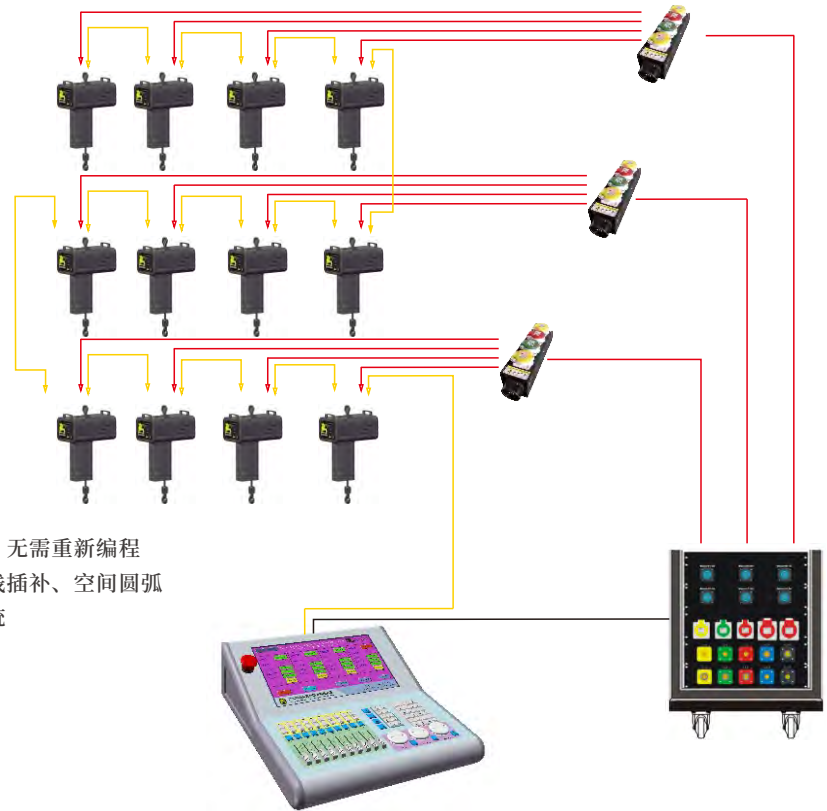

- Independent research and development of professional mechanical digital console,
- 15.6-inch touch screen,
- 2D/3D simulation software,
- 10 channels Broadcast control Manual push rod,
- Multi-purpose combination function runner,
- Multi-mode shortcut selection key,
- Small keyboard fast numeric input,
- 256 axis motion control,
- USB port program import,
- Support DMX512, TCP and other external communication interface protocols,
- Operating voltage: 100-240V (50/60Hz),
- Overall dimensions: W486×D505×H160mm,
- Simple, intuitive and safe wiring system ;
- Real-time manual control of the electric hoist during installation and disassembly ;
- The electric hoist can be combined freely to increase or decrease the number of electric hoists without reprogramming;
- Can choose acceleration and deceleration curve, linear interpolation, circular interpolation, helical interpolation, space circular arc;
- Support multi-task, multi-axis group, multi-axis cooperative motion control software system ;
- Remote Control Visualization Online Technical Support;
- Software emergency stop or emergency stop system;
- Specially dedicated air box, to minimize loading time .

## 电动葫芦设备部件/Electric hoist equipment parts

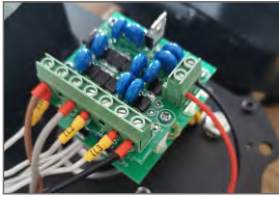

### 科学设计/Scientific design

结构设计合理，加快检修效率，电机、电路板、刹车系统独立设计，高力矩直流电刹车，为长时间使用提高寿命。双层双向自动修正防卡链系统，高强度耐磨尼龙材料，整体一次性注塑成型，维护更换简单。

Reasonable structure design, speeding up maintenance efficiency, independent design of motor, circuit board and brake system, high torque DC electric brake, prolong service life. Double-deck two-way automatic correction anti-jamming chain system, high-strength wear-resistant nylon material, integral onetime injection molding, easy maintenance and replacement.

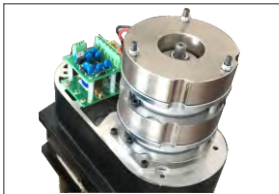

### 双刹车系统/Dual brake system

双刹车系统采用直流刹车4摩擦片式，安全系数更高。

The double brake system adopts DC brake 4 friction plate type, which has a higher safety factor.



### 传动装置/Transmissions

硬质铬锰钢高精度斜齿轮传动，无声运转。齿轮箱机油永久润滑，耐磨静音。

Hard chromium-manganese steel high-precision helical gear transmission, silent operation. Gearbox oil is permanently lubricated, wear-resistant and silent.



### 电机/Electric engine

F级绝缘耐高温电机线圈。

H级耐高温电机引出线。

IP54防护等级。

F level insulation heat-resistant coil.

H level heat-resistant outlet

IP54 protection class, can be used in tropics.



### 电动葫芦控制盒/Electric hoist control box

用于控制1台或2台电动葫芦。

防水航空插头，带紧急停止按钮控制盒。

Used to control 1 or 2 electric hoists.

Waterproof aviation plug with

emergency stop button control box.



### 电动葫芦连接电缆/Electric hoist connection cable

防水航空插头，4×1.5mm<sup>2</sup>国标电缆。

Waterproof aviation plug,

4 x 1.5mm<sup>2</sup> national standard cable.

## 电动葫芦设备部件/Electric hoist equipment parts

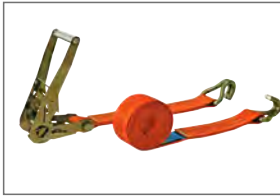

### 拴紧器/Fasten device

标准长度8米，可定制1--50米。  
使用环境温度-40°C→100°C。  
符合欧洲标准EN12195-2。

Standard length of 8 meters, can be customized  
1- 50 meters.  
The ambient temperature is -40°C→100°C.  
Comply with European standard EN12195-2.



### 卸扣/shackle

美标D型  
产品优质合金锻造，表面电镀处理。  
强度80等级，4倍安全系数。

American standard type D  
Products high - quality alloy forging, surface plating  
treatment.  
Strength grade 80, 4 times safety factor.

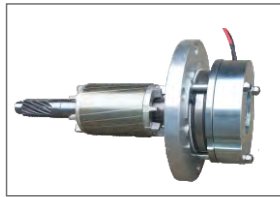

### 维修率小，易于检修/Low maintenance rate and easy maintenance

独立的刹车制动器，可快速发现问题和快速检修。终身无需再加齿轮润滑油，不会出现在演出使用时滴油的情况。  
Independent brake brakes can quickly detect problems and fast overhaul. There is no need to add gear lubricant to the whole life.



电动葫芦控制系统设备/Electric hoist control system equipment



型号Model:KLT-4P



型号Model:KLT-8P



型号Model:KLT-8GP



型号Model:KLT-12P



型号Model:KLT-16P



型号Model:KLT-24GP



简易式电动葫芦控制器

便携式PC防水箱。  
接头插座符合CEE (IEC)。  
4、6、8、12路通道同步控制。

Simple electric hoist controller  
Portable PC waterproof case.  
Connector plug conforms to CEE (IEC).  
Control 4, 6, 8, 12 channels synchronous.



机柜式电动葫芦控制器

标准机柜面板箱。  
接头插座符合CEE (IEC)。  
4、6、8、12路通道或定制多通道同步控制。  
适用于与灯光音响机柜流动或固定场演出。

Cabinet type electric hoist controller  
Standard cabinet fixed control box.  
Connector plug conforms to CEE (IEC).  
Control 4, 6, 8, 12 channels or more synchronously.  
apply to light-acoustic cabinet moving or fixed place.



型号/Model:KLT-8MP

### 电动葫芦航空箱/Electric hoist flight case

- 箱内有保护胶棉
- 四个把手和万向脚轮
- 便于搬运及流动演出使用
- 箱盖装有轮窝，可上下叠起，方便储运。
- The box contains protective collodion.
- Four handles and casters.
- Easy to carry and flow performance.
- The cover is equipped with a wheel nest, which can be stacked up and down for convenient storage and transportation.



### 圆形吊装带/Round lifting strap

采用高强度聚脂工业长丝(100%涤纶丝)制成，内部承载心无极环绕循环状构成，外部使用100%PES织成不受力套管对承载芯加以保护。轻便柔软、在狭小的空间也能使用；不导电，无触电危险；耐热性好，最高可达120度。符合欧洲标准EN1492-2:2000和中国行业标准JB/T8521-2007。

Adopts high-intensity polyester industrial filament (100%polyester silk).internal bearing is surrounded by infinite loop,external part is a sleeve woven with 100% PES,subject to no load which protects bearing core.

Soft and light,can use even in small room,No electrical conducting,no electric shock danger.Good heat resisance with max endurance 1200.

Conforms to european standard EN1492-2:2000 and Chinese standard JB/T8521-2007.



## 圆形吊装带吊装方式、最大安全工作载荷 Circular sling hoisting mode and maximum safe working load

		最大安全工作载荷 = 方式系数P × 额定载荷 Max.SWL=Mode Coefficient P × Working Load Limit						吊装方式最大安全工作载荷 Max.SWL of lifting method				近似宽度 Approx Width (mm)
吊带型号 Code	颜色 Color	1根吊装带正常载荷 Single Max. Working Load Limit						2根吊装带正常载荷 2-Legs Max. Working Load Limit				
		直吊拉力 Upright	结套拉力 Choked	β				直吊拉力 Upright 45°	结套拉力 Choked 45°	直吊拉力 Upright 45° — 60°	结套拉力 Choked 45° — 60°	
		1.0	0.8	0° — 7°	7° — 45°	45° — 60°	45°	1.4	1.12	1.0	0.8	
EA-01	紫色	1000	800	2000	1400	1000	700	1400	1120	1000	800	40
EA-02	绿色	2000	1600	4000	2800	2000	1400	2800	2240	2000	1600	50
EA-03	黄色	3000	2400	6000	4200	3000	2100	4200	3360	3000	2400	60
EA-04	灰色	4000	3200	8000	5600	4000	2800	5600	4480	4000	3200	70
EA-05	红色	5000	4000	10000	7000	5000	3500	7000	5600	5000	4000	75
EA-06	棕色	6000	4800	12000	8400	6000	4200	8400	6720	6000	4800	80
EA-08	蓝色	8000	6400	16000	11200	8000	5600	11200	8960	8000	6400	90
EA-10	精红	10000	8000	20000	14000	10000	7000	14000	11200	10000	8000	100

## 圆形吊装带使用注意事项 Notice on the use of circular hoisting belt



使用之前先检查吊带，是否完好，方可使用。  
Sling should be examined before using, if intact.

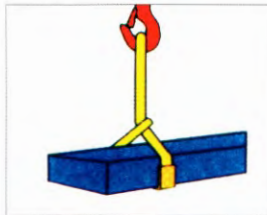

如果悬挂物有尖利边角的话，请使用护套保护吊带。  
Use a protection sleeve in case of lifting items with sharp edges.



请注意挂钩  
Watch the angle

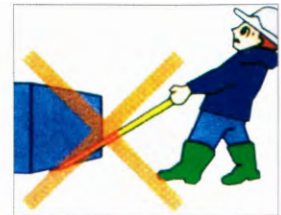

不允许把物品压在吊带上，不允许用吊带拖拽物品。  
Do not allow the load to rest on the sling. Do not drag the load on the sling

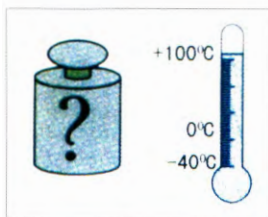

不要超载并注意温度。  
Do not over load the sling and take notice of the temperature.



小心化学品  
Be careful with chemicals

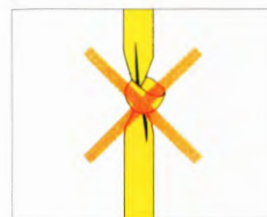

不允许将吊带打结、扭曲。  
Slings should never be knotted or twisted

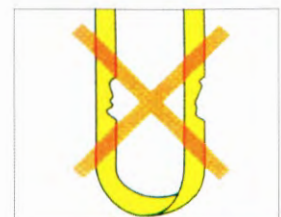

禁止使用破损的吊带。  
Do not use damaged slings.



## 公司环境/Company environment



## 生产车间/Production workshop

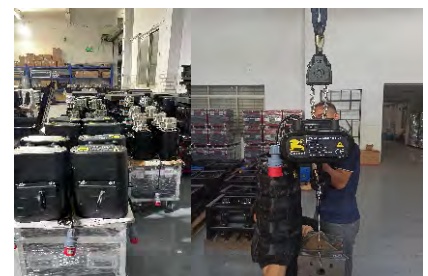
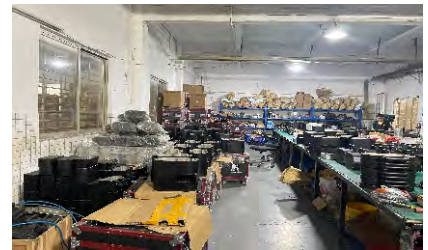



# 工程项目案例/Engineering project cases

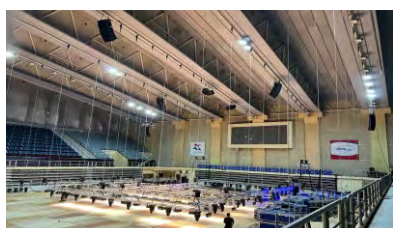
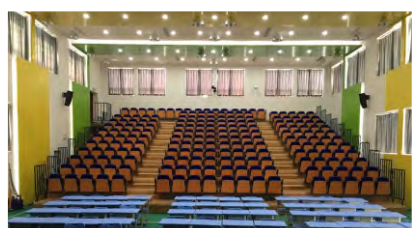



# 工程项目案例/Engineering project cases

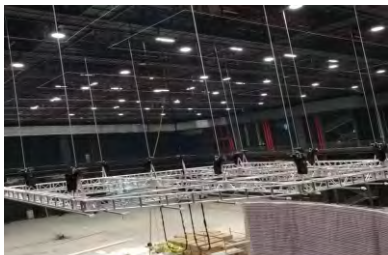
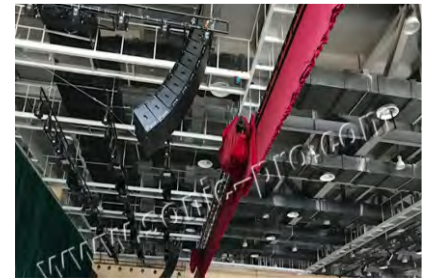
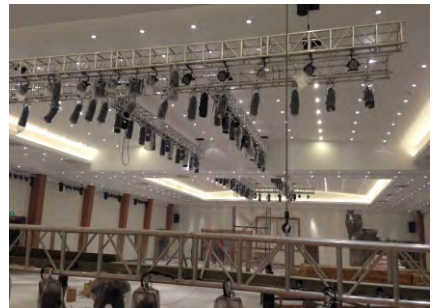
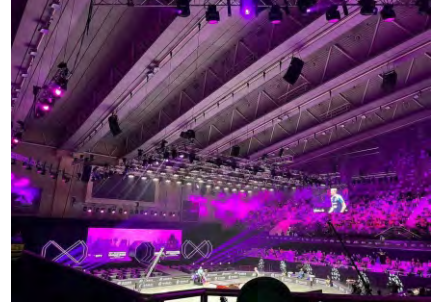





# 常规信息

任何产品的滥用或误用COREAT公司不承担任何责任。产品提供相应明确说明，确保用户对该产品的正确使用完全熟悉。警告和规定作为辅助工具，让用户更好的理解产品使用程序和使用标准。

### 重要

如果设备没有合理的安装、操作及运行，那么所有机械设备的使用可能会对人身财产安全造成损害。使用链条、附件、绑带、起重夹或硬件前，用户应非常熟悉应用安装、运行和维护要求。

#### 遵循以下常规预防措施也将有助于保护运营商和材料设备:

- ☆ 使用前检查设备，若链条、吊钩、卸扣、链节、夹子或其它设备组件出现弯曲、拉长、划痕、磨损过大或损坏等现象，请不要使用。请确保螺母、螺栓、销和其他紧固件紧固，确保夹子功能性良好，并能控制负载。
- ☆ 不超过设备的工作载荷。
- ☆ 在吊钩，夹具，环等设备部件上居中负载。在螺栓和螺栓上使用间隔垫片是必要的，以保持负载居中。
- ☆ 不要使得钩销承受负载;钩销是在链条或索具松弛状态下用来保证不松脱的。
- ☆ 施加载荷时，避免突然加载，快速加载应用可能产生过载
- ☆ 不要使链条打结或扭曲，并始终以直拉方式进行应用负载。
- ☆ 仅使用合金链和链节(80级)用于高空吊装。
- ☆ 只有被授权并经过适当培训才可以使用夹具和起重设备

### 注意

对于任何产品的滥用或误用COREAT公司不承担任何责任。产品提供了明确说明，使用户对该产品的正确使用完全熟悉。警告和规定帮助用户正确理解使用程序和使用标准，如果产品负载超过工作载荷或违规滥用，制造商不负任何损害赔偿任。

### 维护/更换承诺:

COREAT公司承诺每个正常使用的新型链条及锻造产品在材料和工艺上没有缺陷。在此承诺之下，我们的义务尽可能减少我们的工厂产品和其零部件的缺陷，可在产品使用一年内返还有缺陷的产品，并在我们的测试下披露产品缺陷。对于已在任何非COREAT公司授权的工厂修理、退火、电镀或热处理的产品，则此承诺保证无效。

本保证是明确的，以代替所有其他明示或暗示的保证，以及我们的所有其他义务或责任，我们既不承担也不授权任何人以我司名义承担销售或使用链条和锻造产品的相关责任。

## General information

COREAT assumes no responsibility for misuse or misuse of any product. The product is provided with clear instructions to ensure that the user is fully familiar with the correct use of the product. Warnings and regulations serve as auxiliary tools to allow users to better understand product procedures and standards.

### Significant

If the equipment is not properly installed, operated and operated, then the use of all mechanical equipment may cause damage to the safety of people and property. Before using chains, accessories, straps, lifting clips or hardware, users should be very familiar with application installation, operation and maintenance requirements.

#### Following these general precautions will also help protect operators and material equipment:

- ☆ Check the equipment before use, if the chain, hook, shackle, chain link, clip or other equipment components are bent, elongated, scratched, worn or damaged, please do not use. Make sure the nuts, bolts, pins and other fasteners are fastened to ensure that the clips are functional and can control the load.
- ☆ Do not exceed the working load of the equipment.
- ☆ Center the load on hooks, fixtures, rings and other equipment parts. The use of spacer spacers on bolts and bolts is necessary to keep the load centered.
- ☆ Do not make the hook pin bear the load; Hook pins are used to ensure that the chain or rigging is loose and does not come loose.
- ☆ Avoid sudden loading when applying load, fast loading of applications may produce overload.
- ☆ Do not knot or twist the chain, and always apply the load in a straight pull.
- ☆ Only alloy chains and links (grade 80) are used for high-altitude hoisting.
- ☆ Clamps and lifting equipment can only be used if authorized and properly trained.

### Note

COREAT assumes no responsibility for misuse or misuse of any product. The product provides clear instructions to make the user fully familiar with the correct use of the product. Warnings and regulations help the user to correctly understand the procedures and standards of use, and the manufacturer is not liable for any damages if the load of the product exceeds the operating load or if it is misused in violation of regulations.

### Maintenance/Replacement Commitment:

COREAT promises that every new chain and forged product in normal use is free from defects in materials and workmanship. Under this commitment, we are obliged to minimize defects in our factory products and their components, to return defective products within one year of product use, and to disclose product defects under our testing. This undertaking warranty is void for chain products or counterfeit products that have been repaired, annealed, plated or heat-treated at any non-COREAT authorized facility. This warranty is express and in lieu of all other warranties, express or implied, and all other obligations or liabilities of us, and we neither assume nor authorize any person to assume responsibility in our name for the sale or use of chain and forged products.



- +86 18824701468
- <https://globalcoreat.com>
- Email : [info@globalcoreat.com](mailto:info@globalcoreat.com)
- 2 Qingfeng Road,Shawan Street,panyu District,Guangzhou,China